

Quick Installation Guide

Portable 3G/4G Wireless N Router

TL-MR3020



Determine Operation Mode

Refer to the following scenarios to determine an appropriate operation mode.



7106506547 REV2.0.0

Mode Switch	Operation Mode	Scenario
3G/4G	3G/4G Router	I want to share the 3G/4G network with my local devices.
WISP	WISP Client Router	I want to have Internet access from a Wireless Internet Service Provider (WISP), and share the Internet with local devices.
AP	Access Point	I want to access the Internet wirelessly, but only a wired network is available.

Configure the Router

• 3G/4G Router

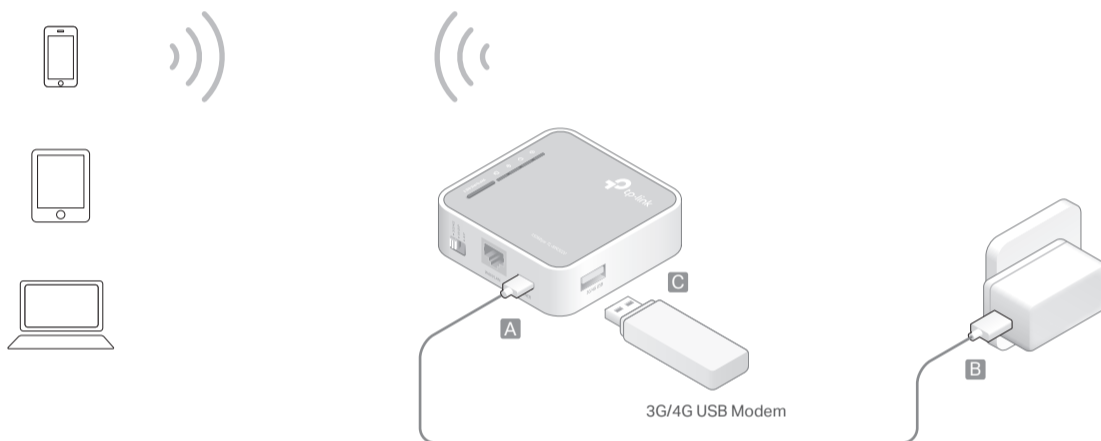

- 1 Switch the operation mode to **3G/4G** and connect the hardware according to the left diagram.
- 2 Connect your device to the router wirelessly . The SSID (wireless network name) and password are on the router's label.
- 3 Launch a web browser and type <http://tplinkwifi.net> in the address bar. Enter **admin** for both username and password to log in.
- 4 Go to **Status** to verify that 3G/4G USB Modem is **Identified**. If it is not, go to FAQ > Q4.
- 5 Go to **Quick Setup** and click **Next**. Select the **Internet Access Mode** as needed and click **Next**.
- 6 Select your **Location** and **Mobile ISP** or manually set them if you ISP is not listed. Click **Next**.
- 7 (Optional) Select **WAN Connection Type** if you have selected 3G/4G Preferred, WAN Preferred or WAN Only as Internet Access Mode. And then click **Next**.
- 8 Either customize your **Wireless Network Name** and **Password** or keep the default ones, and then click **Next**.
- 9 Click **Finish** to apply the configuration.

! If you have changed the default SSID and password, you have to reconnect your wireless devices to the new Wi-Fi network.

• WISP Client Router

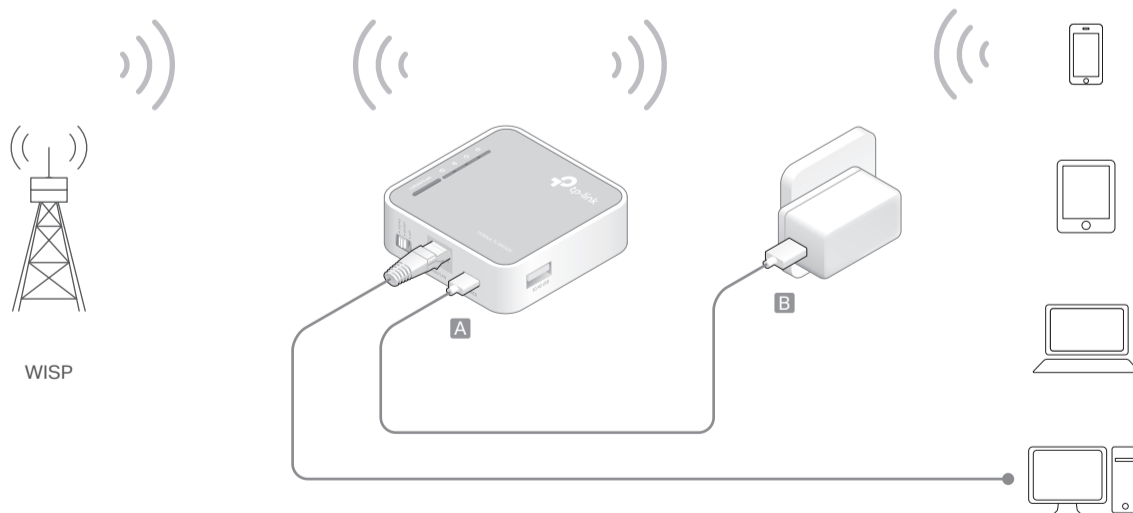

- 1 Switch the operation mode to **WISP** and connect the hardware according to the left diagram.
- 2 Connect your device to the router wirelessly or via an Ethernet cable. The SSID (wireless network name) and password are on the router's label.
- 3 Launch a web browser and type <http://tplinkwifi.net> in the address bar. Enter **admin** for both username and password to log in.
- 4 Click **Next** and select **WAN Connection Type**.
 - If **PPPoE** is selected, enter the **User Name** and **Password** provided by your WISP and then click **Next**.
 - If **Dynamic IP** is selected, click **Next**.

Note: If your current device is not the one initially connected to the ISP's device, go to **Network > Mac Clone** to clone the Mac address of that device.

 - If **Static IP** is selected, enter the **IP Address** and **Subnet Mask** provided by your WISP and then click **Next**.
- 5 Click **Survey** to find the corresponding network of your WISP and click **Connect**. Select the **Key type** and enter the **Password** of the selected wireless network.
- 6 Customize the **Local SSID** as your wireless network name and **Wireless Password** or keep the default settings, and then click **Next**.
- 7 Click **Finish** to apply the configuration.

! If you have changed the default SSID and password, you have to reconnect your wireless devices to the new Wi-Fi network.

• Access Point

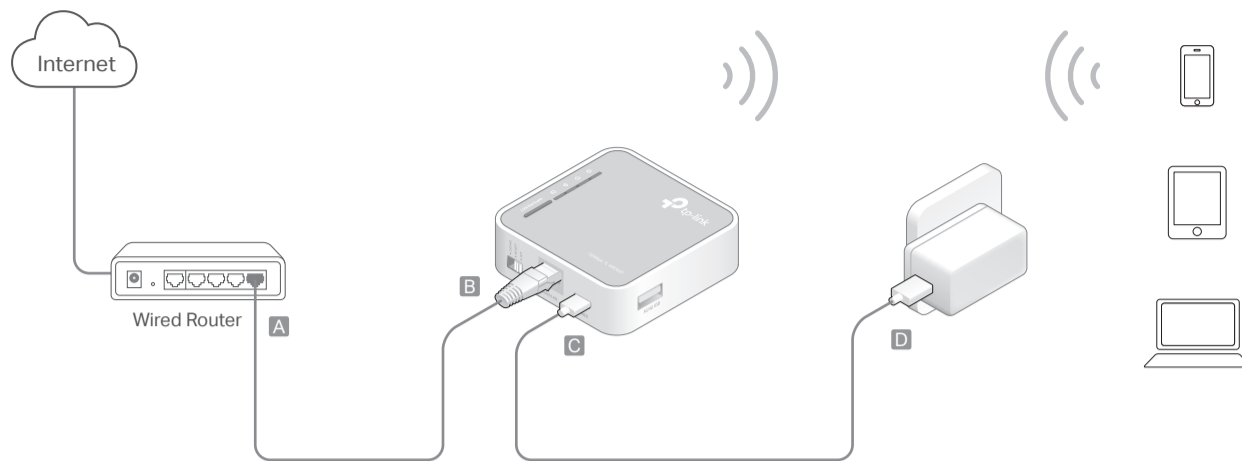

Note: By setting the switch to AP Mode, you can also access four other modes: Repeater, Bridge, Client and Multi-SSID. For details, please refer to the User Guide at www.tp-link.com.

- 1 Switch the operation mode to **AP** and connect the hardware according to the left diagram.
- 2 Connect your device to the router wirelessly. The SSID (wireless network name) and password are on the router's label.
- 3 Launch a web browser and type <http://tplinkwifi.net> in the address bar. Enter **admin** for both username and password to log in.
- 4 Click **Next**, select **Access Point** and click **Next**.
- 5 Customize the **Wireless Network Name** and **Wireless Password** or keep the default ones, and then click **Next**.
- 6 Keep the default setting for most cases or customize the settings of **DHCP Server**, **IP Address** and **Subnet Mask**.
- 7 Change the **login account** of the management page or keep the default one.
- 8 Click **Finish** to apply the configuration.

! If you have changed the default SSID and password, you have to reconnect your wireless devices to the new Wi-Fi network.

FAQ (Frequently Asked Questions)

Q1. What can I do if I forgot my web management password?

- Refer to FAQ > Q3 to reset the router, and then use the default **admin** (all lowercase) for both username and password to log in.

Q2. What can I do if I cannot log in to the web management page?

- If the computer is set to a static or fixed IP address, change the setting to obtain an IP address automatically.
- Verify that <http://tplinkwifi.net> is correctly entered in the web browser. Alternatively, check spacing and enter <http://192.168.0.254> in the web browser.
- Use another web browser and try again.
- Reset your router to its factory default settings (FAQ > Q3) and try again.
- Disable and then enable the network adapter in use.

Q3. How do I restore the router to its factory default settings?

- With the router powered on, press and hold the **WPS/Reset** button for 8 to 10 seconds and then release the button.

Q4. What can I do if I cannot access the Internet with an identified 3G/4G USB modem?

- Insert a suited SIM/UM card into the 3G/4G USB modem correctly.
- Plug your 3G/4G USB modem directly into your PC and disable the PIN verification via the modem utility.
- Verify that the 3G/4G USB modem works well on your PC.
- Consult your ISP for the latest dial number and APN (Access Point Name), and correct the preset information manually.

Q5. What can I do if the "Unknown Modem" message displays?

- Launch a web browser, enter www.tp-link.com in the address bar and go to **Support > Compatibility List**. And check whether your 3G/4G USB modem is on the **3G/4G Compatibility List**. If the latest firmware or bin file doesn't support your modem, please contact our technical support.

Q6. How to update the firmware of the router?

1. Go to the product page of TL-MR3020 at www.tp-link.com, click **Support > Firmware** and download the the latest firmware.
2. Connect your computer to the router via an Ethernet cable (recommended) or wirelessly.
3. Log in to the web management page and go to **System Tools > Firmware Upgrade** to update the router.

Hardware Information



LEDs:

LED	Status	Indication
⏻ (Power)	On	The router is on.
	Off	The router is off.
☁ (Internet)	On	The Internet is available.
	Flashing	The router is transferring data.
	Off	The Internet is unavailable.
📶 (Wireless)	On	The wireless network is enabled.
	Flashing	There are data being transferred via the wireless network.
	Off	The wireless network is disabled.
🌐 (WAN/LAN)	On	The Ethernet port is connected.
	Flashing	There are data being transferred via the Ethernet port.
	Off	The Ethernet port is not connected.

Ports & Buttons:

Port/Button	Description
Mode Switch	This switch is used to determine the operation mode of the router.
WAN/LAN	In 3G/4G Router Mode, this port functions as the WAN port when WAN Only, WAN Preferred or 3G/4G Preferred is selected, and as the LAN port when 3G/4G Only is selected. In WISP Mode, the port functions as the LAN port and in AP Mode the WAN port.
Power	The port is used to connect the power adapter.
WPS/RESET	To establish WPS connection, push the WPS button on your device and then push and hold the WPS button on this router for less than 5 seconds. To reset the router, push and hold this button for at least 10 seconds.
3G/4G USB	This port is used to plug a 3G/4G USB modem into.